

# Sheltered Housing Scheme



## Buckwyns Court



- ◆ Buckwyns Court is a complex of ground and first floor flats arranged around a small central court yard. The scheme is located in Billericay off of Rosebay Avenue
- ◆ The Local Area (Central) Housing Office is located on the ground floor of the Basildon Centre, in the Town Centre (01268) 294500

- ◆ The Sheltered Scheme Co-ordinator can be contacted on (01277 626186)
- ◆ The nearest shops are a 10min walk from the scheme and include a Somerfield store, newsagents, chemist and opticians. The nearest Post Office is less than 1/2 mile from the complex in Perry Street
- ◆ The nearest Doctors Surgery is in Queens Park Avenue approx ½ mile from the scheme, whilst the nearest Dental practice is approximately 200yds from the complex near the parade of shops
- ◆ First National buses serve the complex from a bus stop approx 50m from the complex in Rosebay Avenue

### Useful telephone numbers

Applications/Allocations - 01268 294099    Benefit Agency - 01268 363000  
Supported Housing Officers - 01268 465322

# Buckwyns Court

FLATS



*The Common Room*

- ◆ Buckwyns Court has a Common Room for use by the tenants and the activities include: - Bingo on Weds evening, Sewing on Tues and Thurs am, with a Social evening once a month on Sat. Outings are arranged on a monthly basis from June to October

- ◆ Individual flats at the Buckwyns Court complex have their own front door but are linked to the Scheme Coordinator and/ or Careline by an Alarm System ensuring privacy, security and peace of mind

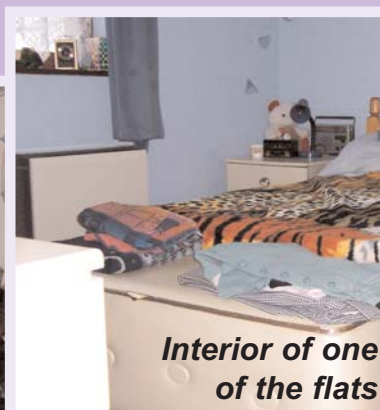

*Interior of one of the flats*

- ◆ **Supported People Charge** is a separate amount payable in addition to your rent to cover the costs of the Sheltered Housing Scheme Coordinators and your Support Plan. It will be approximately £21 a week. If you are receiving Housing Benefit or if you were a council tenant before April 2003 this charge will be paid for you
- ◆ **Service Charges** cover the cost of heating, lighting, cleaning and maintaining the communal areas and are also payable in addition to your rent. The cost will be approximately £6 a week and if you are receiving Housing Benefit it will be paid for you

